

EXPECT TO ACHIEVE

Newman University

Landscape Management Plan

July 2017

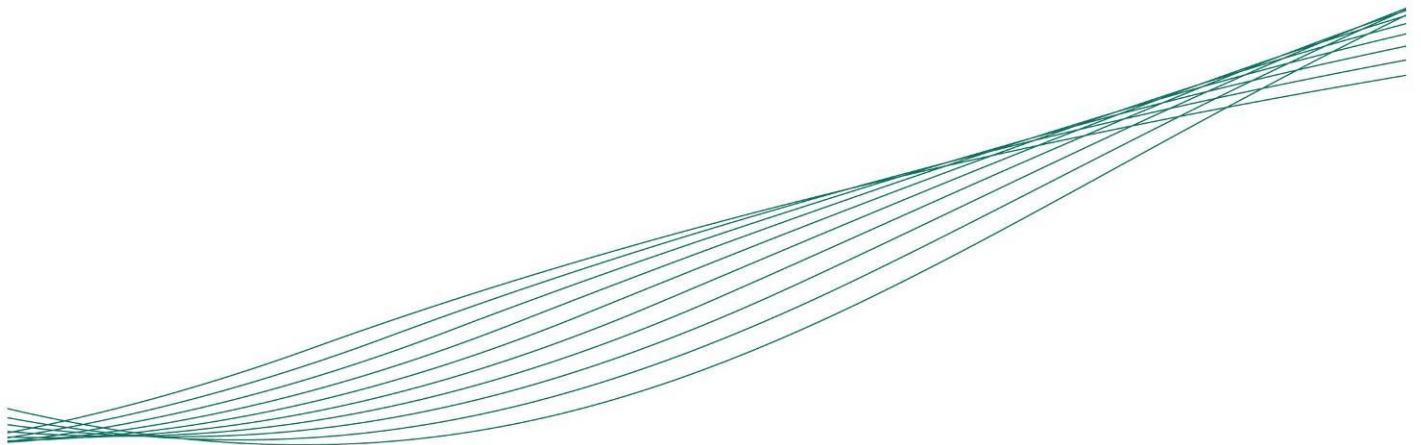

Introduction

Location

The Newman University campus is situated in Bartley Green on the outskirts of south west Birmingham, overlooking Bartley reservoir and the Worcestershire countryside beyond and some 8 miles from the city centre.

The location of site means we are accessible by bus, bike, car or on foot. The positioning of our local public transport means we have local buses into Birmingham City centre every 15 minutes during the week and also into local high streets every 8-15 minutes.

Current Use

Newman University is made up of two faculties – the Faculty of Education and the Faculty of Arts, Society & Professional Studies.

It has lecture theatres, general purpose teaching rooms, science and sports science laboratories, IT suites, a library and sports centre providing all the specialist equipment necessary to support the wide range of courses offered. A health and wellbeing centre, two halls of residence, a students' union, sports pitch, cafes and on-site bar provide all the facilities to make this an independent Campus.

Over £22 million is being invested on improving the campus for students, redevelopment on some aspects of the campus began back in 2010 and has so far included Chapel, Psychology building and Sports Centre. Work will soon be completed on a new Halls of Residence, new Atrium and additional teaching spaces with further work planned on the Teaching block – Darwin Building.

Catholic Ethos

Newman's mission is centred on the Catholic values of tolerance and inclusion. As a Catholic University, Newman is proud to welcome students and staff of all religions and backgrounds.

We are named after our Patron, Blessed John Henry Newman, who was a Cardinal of the Catholic Church and Beatified in September 2010 by Pope Benedict XVI.



Intensive Landscaping Improvements

We have undertaken intensive landscaping improvements across the campus. These improvements will continue as part of the new buildings and refurbishments. This work will ensure that we are giving our students the best experience possible during their studies whilst making sure we are keeping up to date with best practice with regard to landscaping.

The Grounds of Newman

With the site being built around the 'Heart of the Campus' – our Chapel, Newman consists mainly of buildings set around quads, courtyards and open spaces for students to study and relax. In addition to the buildings we have a new sports pitch. We also have many parks and fields surrounding the University site as well as the adjacent Bartley Reservoir, woodland, walking routes and sports fields.

In between buildings there are a variety of open spaces and courtyards which provide a pleasant setting for staff and students to spend time, including more peaceful areas, such as around the pond in front of Edgbaston Halls of Residence. The landscaping includes many mature trees and year round planting gives a colourful backdrop to the buildings.

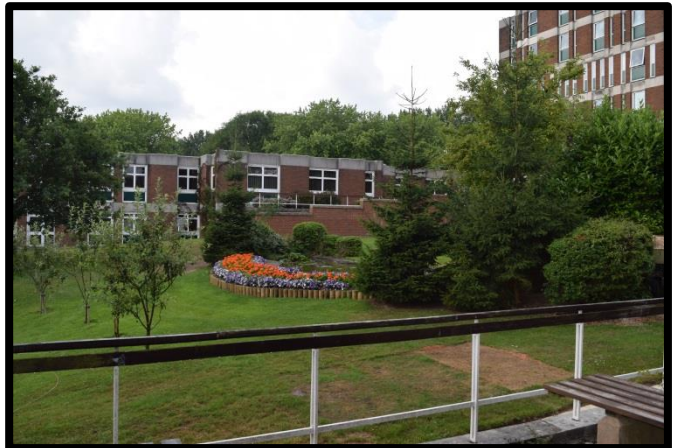

Newman University Sports Centre is situated within the Edwards Building. The University Sports Centre was officially opened by Olympic bronze medallist, Kristian Thomas. The Sports Centre facilities are accessible to students, staff and local community members and include a recently refurbished Cardio Suite and a Sports Performance Suite, which enable members to achieve a broad range of fitness goals. Alongside this we secured a grant from the FA to install a brand new All Weather Pitch of artificial grass made to the latest specifications.



Recent and upcoming Development

Newman's impressive library (St Chad building) opened for business on 30 September 2011. Students now have access to books, journals and electronic resources in a wonderful building which encompasses additional teaching rooms, individual and group study areas as well as Newman's specialist collections. Relaxing sofas incorporating power sockets allow students to plug in their laptops or iPads and study in a comfortable environment whilst enjoying superb views over Bartley Green reservoir and the Worcestershire countryside beyond. With this development came a refurbishment of our Ryland Quad bringing in a seated area surrounded by flowering shrubs and trees for staff and students to enjoy.



We are now currently working on the next phase of a campus development, investing £22 million over five years. Work on the first phase of the programme began in April 2016 and will include a new, 10,000m², double-storey extension, update to our Sanctuary café, a 104-room hall of residence and the refurbishment of four existing buildings, including our wonderful St Mary's Chapel. The Chapel now has a bridge filling an unused space leading to a main building on campus and the main reception, meaning easier access to the heart of our campus. The walkway contains benches, flower beds and external lighting.

The summer of 2016 also saw the development of a new car park following the demolition of Newman College Close, this incorporated 67 new parking spaces onto campus.



A Warm Welcome

As well as being a very important part of university life for staff and students, we also provide areas that are accessible for use by our local community.

These include areas such as the Atrium Café located in St Chad building, the Sports Centre and All Weather Pitch

Newman University is keen to safely increase public access to the site and is currently looking at how this can be managed to balance the needs of both the University and the community.

Where it can Newman seeks to maximise the public involvement with different opportunities to access our campus through events such as family fun days, community events, celebration events and more.

Getting around Newman's Campus

All Newman staff and students are required to carry their own personal ID card at all times to gain access to the main campus. Visitors are expected to park in the visitors car park and report to Reception to sign in and obtain a visitors pass. There are maps available to find the best route around campus, and signage around every building to help you further.

Around campus we have 327 for students and staff with a permit to use and also 3 different areas around campus to be able to secure bicycles for those wishing to cycle to University.

The student car park has had a recent extension which added almost 67 car parking spaces to the campus. This was the result of a demolition of "Newman College Close".

The University promotes sustainable travel wherever possible. We have some parking bays on site for multi-occupancy cars, secure places for people to lock up their bicycles and we have regular events where we promote cycling to Newman, walking, car sharing and public transport.

Around Newman we try and be as accessible as possible for all students and to meet the needs of people with disabilities. This has included level or ramped access into most buildings and lifts and automatic doors being installed around campus. When we consider any new developments we always make sure extensive consideration is given to DDA compliance.



Safety, Security, Health and Wellbeing

On-site Security

There is a 24/7 security presence across campus which includes regular campus patrols and CCTV covering the whole site. The Security team are easily contactable on internal phone lines and also through the main telephone line out of hours.

Our Estates team work very closely with the Security team to ensure that our CCTV views covering the areas both around and within the buildings are not obstructed and we have good sight around campus and the access routes to buildings.

Any incidents that we do have on site are always recorded and logged by our Security team and kept on file. This allows the department to keep a log and review progress and to try and reduce the likelihood of any similar events happening in future.

Keeping the campus safe

Newman University has a dedicated maintenance team on site who are available throughout the day during the week. They are also on site at weekends carrying out repairs, upgrades and other essential works around campus.

We have an email system where anyone can report a maintenance problem to the Estates department and these will get picked up and dealt with as soon as possible. The equipment used to maintain the grounds is inspected annually to ensure its safety. We make sure that our trees, sports pitch and general grounds are all surveyed upon advice from consultants and their condition is inspected.

Health and Safety

The health and safety team work very closely with the Estates department to ensure safety across the whole site for staff, students, contractors and visitors. Risk assessments are needed and used across all departments and then reviewed by the Health and Safety officer before any event or activity can be

signed off. These are all kept up to date and reviewed regularly to maintain standards. COSHH assessments are always recorded and kept up to date and training for relevant staff is recorded to ensure that training can be kept up to date too.

All staff working around the grounds are provided with any PPE they may need to wear or use. In addition, contractors are checked that they have the necessary safety equipment before they begin any work on the site. We have an up to date team of first aiders on site and located in every building to enable a fast response should urgent care be needed. Our security guards are also trained in first aid and can provide out of hours support. A list of first aiders is accessible for any staff member with access to SharePoint.

Accident Reports

There is a system on site where all accidents and near misses should be reported to the Estates department. This is to ensure any potential dangers are reviewed and made as safe as possible. These results are monitored and analysed by our health and safety department who are able to conduct investigations should they need to.

Our Fish pond and Gardens

We have a fish pond at the University, located outside of Edgbaston block, within the inner quad, this houses a variety of cold water fish, including green carp, gold fish, the pond also houses several well established lily plants, along with oxygen plants. A secluded bench area is also nearby allowing another place for the students and staff to relax in a peaceful, well maintained area.



A Clean Campus

A clean campus is very important to Newman University and we pride ourselves on appearance and endeavour to give an excellent first impression. As well as being attractive to potential students this provides a pleasant environment for staff and students. Our Estates team and contractors are responsible for maintaining the campus and this involves arranging for waste to be collected and recycled where possible off site. We have a housekeeping team on site throughout the day and of a Saturday morning, who also clean across campus to make sure our grounds are looking tidy. We sweep our sports pitch at least once a week to keep it looking and feeling clean and free of any foreign objects as well as keeping it free of litter.

To encourage all people on site to help keep the campus clean and tidy there are a number of recycling areas installed around campus (including the halls of residence) as well as general litter bins.



Environmental Sustainability

Maintenance

Our maintenance team and contractors are responsible for the upkeep of the grounds, helping to maintain the high standard of appearance of our grounds. The teams regularly meet with the Estates department to discuss new priorities and current changes and plans whilst analysing the wider campus and planning future works.

Tree Management

Newman University's landscaping includes various species of trees placed around our campus. Should it be necessary to remove a tree, as specified within Newman University's environmental policy, it is replaced with an additional 3 trees.

We have a variety of fruit trees at our campus, these include apple, pear and plum. Fruit grown on campus is used within our Catering department.

Equipment Maintenance

All equipment used on site is PAT tested, to ensure we are in compliance with the Health and Safety at Work Act (1974).

We have two vehicles on site which are used by the Estates department and these are serviced, tested, and inspected as required.

Environmental Strategy

Newman University is committed to recognising and reducing its impact on the environment. Positive developments in environmental awareness and research are making a big difference and are supported by an Environmental Policy that is regularly updated and checked that it is still as relevant as possible.

The Environmental Policy should be available for all staff and students to view through our website and SharePoint.

Newman currently takes part in the People and Planet League and are currently placed 105th with the intention of climbing the table.

We approved a Carbon Management Plan in March 2011, and we committed to reduce our carbon footprint by 30% by 2015 and by 43% by 2020. We have just reached our target for 2015 and will continue being energy efficient to reach our 2020 target. To reduce consumption further, we plan to use spaces more efficiently, particularly at evenings and weekends.

Elements that are included in the calculation of Newman's carbon footprint include:

- Energy use in buildings (gas, electricity, heating consumption);
- Newman fleet vehicle use – emissions associated with current vehicle fleet;
- Waste management and recycling – aiming to reduce emissions associated with waste

A copy of the University's Carbon Management Plan can be found on our web site.

Eco Campus

EcoCampus is an Environmental Management System (EMS) and award scheme that has been designed specifically for universities in the UK. It aims to aid institutions in moving towards environmental sustainability through good operational and management practices.

Newman has completed the Gold stage of EcoCampus and is due to be reassessed for re-accreditation in October 2017. Following this we will begin working towards the Platinum award. EcoCampus allows universities to identify, evaluate, manage and improve their environmental performance and practices across the campus.

Recycling and Waste Management

The University now recycles 50 tonnes of materials. In 2011 we used to fill 10 skips with waste each week, but now, since we have introduced a baler on site we have reduced this drastically and now only fill only one skip per week.

Savings and revenues made from selling recyclable materials on the open market are re-invested into other green projects approved by the Environmental Committee.

Cycling

During the year we host at least one "cycle to work" day/week. This is usually held as part of the national Cycle to Work Week and there are usually incentives to encourage staff and students to take part. We are currently in the process of adding cycle routes and times onto our website for those wishing to cycle to Newman from different areas.

There is the option for staff to purchase a bicycle as part of a Cycle to Work scheme.

Renewable Energy

We now have solar panels installed on two of the buildings at Newman - McAuley building and St Chad building and we now produce 10% of our own electricity on campus by using Solar PV. Our new accommodation block has a small microchip (combining heat and power) which produces a further 7kw from supplying hot water and heating to the building

Fairtrade Newman has been awarded the status of a Fairtrade University for the last 10 years. Fairtrade products are available in both our Sanctuary and Atrium Cafés. Each year, with the help of the Students' Union, we take part in Fairtrade Fortnight and try and encourage as many staff and students to get involved.

Cafod Award

In May 2017 Newman University was awarded in achieving the Live Simply Award, this was delivered by the Chaplaincy Department and the award recognises our commitment and actions to live simply, to live sustainable with creation and to live in solidarity with the poor.

Fruit Growth and Bee Keeping

Around campus we have several different places where we are growing our own produce and this is mirrored through some of our current contractors on site also creating small vegetable plots.

We have some areas at the moment growing berries and apples which are used in our on-site Sanctuary Café and we also plan to grow potatoes and install bee hives in the very near future. Bees would bring a great benefit to our campus, which extends past just being able to make our own honey. It would bring an increased impact on pollination across our grounds which will benefit any garden areas that we do have and positively affects the production of vegetables and fruit around campus.



Composting Statement

We have 7 composting areas on site and these are primarily maintained by on-site contractors. These are all located in relevant areas of the campus. This enables all of the grounds waste from the flowerbeds, cuttings from trees and shrubs to be composted. The resulting compost then gets recycled and returned out into our grounds and flowerbeds



Bat Boxes and Swift Holes

In our new halls of residence we have incorporated Bat boxes and also Swift holes. These are built into the actual halls of residence walls so you cannot physically see them from the outside, unless you know what you are looking for (see opposite).

Bats play an important part in our environment as they will only eat insects! So they will not bite humans but they do clear the air of mosquitos and other similar insects, meaning they keep the bugs away from our ponds, our plants and ourselves. They can also help with pollination and seed dispersal. They are an endangered species and are protected all across the UK. Bats are a vital part of our native wildlife, accounting for almost a third of all mammal species in the UK and occupy a wide range of habitats, such as wetlands, woodlands, farmland, as well as urban areas. They can tell us a lot about the state of the environment, as they are top predators of common nocturnal insects and are sensitive to changes in land use practices. The pressures they face - such as landscape change, agricultural intensification, development, and habitat fragmentation are also relevant to many other wildlife species, making them excellent indicators for the wider health of the UK's wildlife.

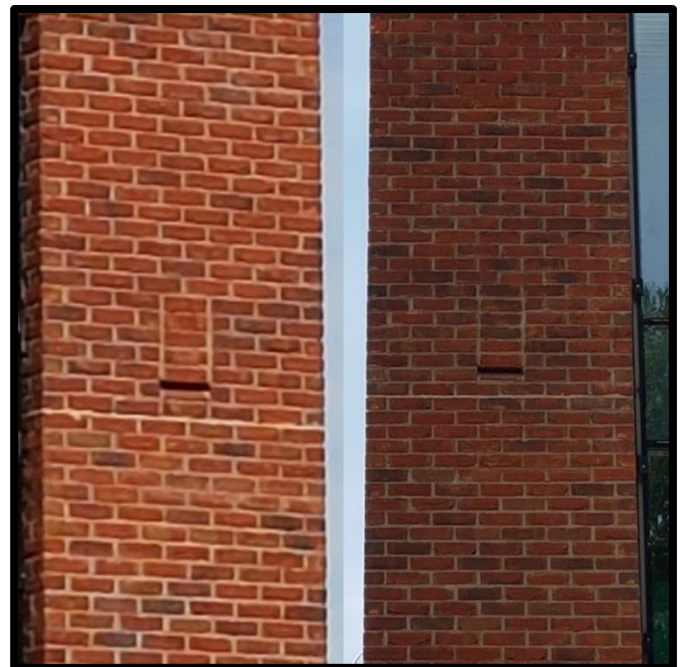

Landscaping Management

Newman University have Wilby's Building Services contracted on site. David Wilby has been working on our site ever since we opened our doors in 1968 when he was initially asked to come and tidy the campus ready for our 'Opening Ceremony' and he impressed from there and has continued working with us ever since. David, his sons and grandsons are still ensuring our grounds are as impressive as ever.

Wilby's Building Services initially looked after minor maintenance works across the campus which then led to David being part of our beautifully kept grounds, building maintenance projects and general campus developments.

The contract is reviewed and re tendered every 5 years.

The schedule of Landscaping can be seen with Appendix 2 of this document.



Community Involvement

We view Newman University campus as an asset to the local community, be it staff, students, local school children, local sports teams, members of the public or other community groups who come to Newman for a range of events throughout the year. We invite the local community to the campus to partake in many events held throughout the year.

We regularly hold open days and applicant visit days for those who are interested in coming to Newman to enable them to see our facilities, campus and to experience a day at Newman as well as speaking to staff and students about their course.

Tree Planting Events

During our 2017 "Green Week" we gave out or planted on site 250 Norwegian Spruce trees. These were taken away by staff or students to be planted in their own homes or gardens with any that were left being planted around the Newman campus. This was the first time an event like this was held on campus and was received very well and gathered positive feedback.

Conferences, Catering and Room Hire

We have various rooms in different buildings across the campus that enable us to host a variety of functions such as seminars, conferences and training days. On-site catering can also deliver hospitality for a range of events.



Sports Facilities

The Edwards building is home to our sporting facilities. Based at the back of our campus we have our Sports Centre and Sports Pitch. Our sports pitch is a 3g all weather pitch which very recently opened after a refurbishment and an upgrade. Our sports facilities are available for use by staff, students and the local community. The facilities include gym rooms, sports hall for basketball and netball, and our sports pitch for football teams.

By opening up this part of the campus to the local community and external sports clubs we are inviting the public to see the other facilities we have on site that they and others may be able to benefit from.

With growing demand from internal and external clubs Newman Sports Centre is always looking to improve and keeps its facilities maintained to a top standard to offer the best experience possible for our student teams and external teams. This also accommodates the rising level of participation in the community and local area.

Educational Activities

Newman's wider campus is used as a teaching, learning and assessment resource, particularly by the Faculty of Education, with students who are studying for careers working with children in schools and in wider services making use of the whole campus. Teaching and learning mainly takes place within the classroom but also uses the greener areas of our campus to give the trainee teachers experience of activities they could undertake with their future classes in the outdoor environment.

Appendix 1





Newman University

Bird and Bat Box Schedule

application ref: 2016/09260/PA (condition 21)

date: 16-02-17

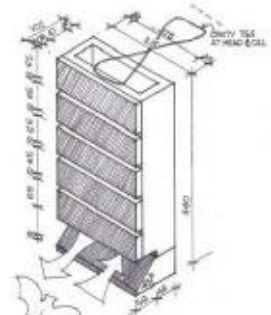
ref.	item	description	Image (note: images are indicative only)
A	Swift bird box bricks	EcoSurv Swift nest box bricks, with brick finish to match approved brick (2no. at 6m in height in locations indicated on location plan)	
B	Bird Nesting Boxes on retained mature tree	Schwegler 1B Nest Box – 26mm Hole (Brown). To be erected on retained mature oak tree.	
C	Bat boxes in brickwork walls	Weinerbeger Terca/EcoSurv Bat Box bricks, with brick finish to match approved brick (3no. at 6m in height in locations indicated on location plan) Products – Habibat 3S & Habibat Combi Box. The latter allows for two boxes to be placed side by side and connected to create a larger roost space.	 

Appendix 2

Grounds and Drainage Maintenance Packages and frequencies

Grounds Maintenance

Task	Frequency
Grass cutting	Minimum every 3 weeks.
Tree pruning, care	Every 2 years
Fruit trees care	Every 4 years
Pond planting	4 seasonal changes
Front Entrance	
Landscaping	Twice per year
Slab treatment	Twice per year
St Chads/ Dwyer	
Pruning maintenance	Twice per year
Planting	4 seasonal changes
Main quad	
Tree pruning	Twice per year
Maintenance	Twice per year
Slab treatment	Twice per year
Gravel maintenance	3 times per year
Other quads	
Maintenance	Once per year
Car park hedges	
Trimming	Twice per year
Weeding	Four times per year
Bark replacement	Every two years
Planting of fruit trees	2 trees every year.
Management of composting	
Address diseased areas when required.	

Drainage Maintenance

Drainage Pots	
Dig out and clean	Once a year
Inspection of retention	
Storm valves.	Once a year
Sewer blockages	As required.
Jetting down of	
Drainage system.	Every 5 years
Camera inspection	As required.
Gutter cleaning	Once a year
	(bad storm may
	Increase to 2)
Down pipe cleaning	Once a year
Roof service	Once a year.

Appendix 3

Local walks.



2.2km around Bartley Green, at a quick pace this will take around 30 minutes.

Around the reservoir this is 3km and will take around 38 minutes.

Appendix 4

EXPECT TO ACHIEVE

Appendix 4

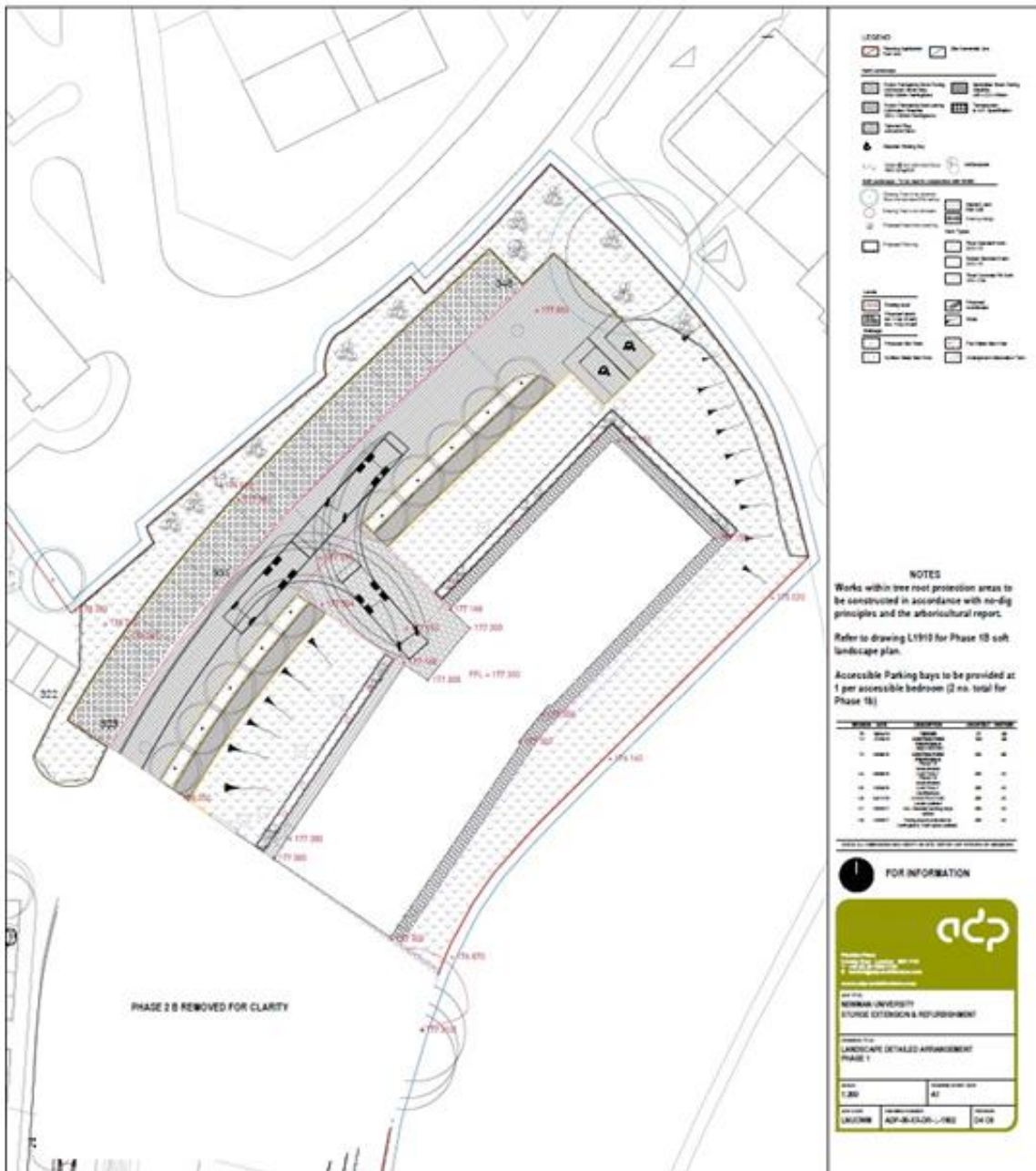

Appendix 5

